

RUOFF & SONS, INC. PRECISION CNC MACHINING

	2.09	Pulley Key
	2.69	Oil Cup
	2.08	Crank Shaft Retaining Ring
	26.29	Eccentric Hex Bushing
0	33.33	Connecting Link
1	1.23	Connecting Link Screw
2	1.23	Connecting Link Pin Retaining Ring
3	6.13	Connecting Link Pin
4	.88	Ram Key Self Lock Pin
5	2.90	Ram Key
6	81.95	Ram
7	not sold or priced seperately	Punch (Standard Special)
7A	1.39	Screw
8	.88	Punch Locating Self Lock Pin
9	.88	Lever Knob Screw
0	5.32	Lever Knob
1	.88	Lever Self Lock Pin
2	16.06	Lever
3	12.05	Stud
4	.88	Top PLate Screws
5	7.45	Top Plate
6	6.08	Coil Spring
7	31.86	Sliding Bracket
8	.88	Sliding Bracket Screw
0A	6.43	Sliding Bracket Bushing
1	2.84	Feed Wheel Spring
2	.88	Feed Wheel Spring Screw
3	13.52	Feed Wheel Shoulder Bolt
4	33.33	Feed Wheel
5	24.15	Rocker Arm
6	1.23	Feed Wheel Shoulder Screw Retaining Ring
7	2.09	Collar Dowel Pin
8	.88	Collar Screw
9	34.13	Collar
2A	32.52	Support Wheel

RUOFF NOTCHER PRICE LIST AS OF SEPTEMBER,1 2012

Part #:	Price	Description
1	840.84	Casting
2	31.42	Crankshaft
4	72.77	Pulley Heavy Duty
5	1.23	Pulley Key

47	1.69	Pawl Spring
48	1.80	Die Screws
49	.50	Table & Spacer Screws
50	Not sold or priced seperately	Die (Standard Special)
51	6.13	Table
52	4.11	Long Spacer
53	3.24	Short Spacer
54	Not sold or priced seperately	Guide Bar (Standard Special)
55	.88	Guide Bar Screws
56	.88	Stripper Plate Dowel Pin
57	Not sold or priced seperately	Stripper Plate (Standard Special)
58	.88	Stripper Plate Screws
59	279.51	Stand
60	55.84	Pulley Guard
61	11.09	Scrap Bucket
62	216.15	Motor Heavy Duty 3/4 H.P.
63	15.95	Motor Pulley Heavy Duty
64	11.79	V-Belt (66" Long)
65	7.98	On-Off Switch
66	11.55	Rubber Cord with Plug
93A	275.00	Non-Marring Feed Wheel Kit (Incl. #42, 27, 31 Spec. 30A)
	236.50	Less #27 and #30A
93B	109.73	Non-Marring Feed Wheel (Left)
93C	121.28	Non-Marring Feed Wheel (Right Knurled)
93D	9.24	Rubber Feed Wheel Ring
93E	1.16	Cap Screws (3)

Punch & Die Units

#1	508.20	"V" Punch & Die Unit
#3	508.20	Slot Punch & Die Unit
#4	698.78	Slot & Hole Punch & Die Unit
#5	418.11	Hole Punch & Die Unit
#2	825.83	Slitting Punch & Die
#6	Prices available upon request	Specials

Compl. Notcher	2357.80	With either style Punch & Die (#1 or #3)
Compl. Notcher	2524.50	With either style Punch & Die (#1 or #3) with Non-Marring Feed Wheel
Overseas Notcher	2725.80	With "V" or Slot Punch & Die
Overseas Notcher	2890.80	With "V" or Slot Punch & Die with Non-Marring Feed Wheel
(#1A)	1867.80	Head Assembly

MINIMUM CHARGE 45.00 ON ALL PARTS ORDERS

F.O.B. - Runnemede, NJ 08078

RUOFF NOTCHER

Automatic Power Notcher
for the Heating, Air Conditioning and Sign Industry

FAST • SIMPLE • FLEXIBLE

"The Best Way to INCREASE PROFITS in an Era of Extreme Competition"

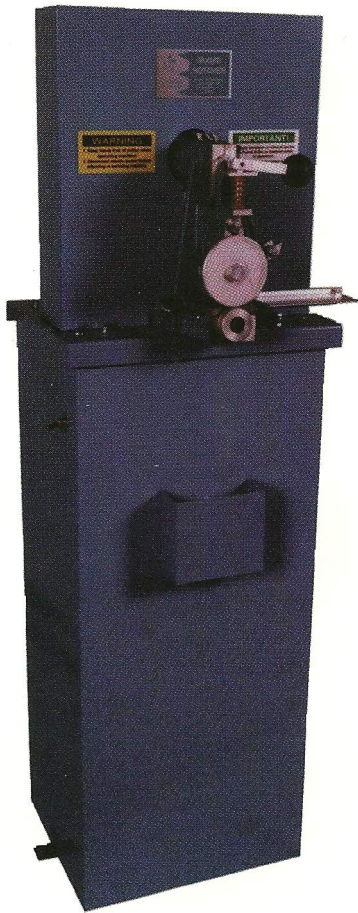

The RUOFF NOTCHER is a punch press with an adjustable automatic feed. It is precision designed for punching various shapes, along the edge of sheet material.

Sheet steel, galvanized iron, aluminum, plastics, cardboard, or any sheet material that can be punched, can be handled by the RUOFF NOTCHER.

Each RUOFF NOTCHER is fully guaranteed for 90 days after date of purchase. Shipping is immediate. The RUOFF NOTCHER is easily installed in less than five minutes.



Shown with optional non-marring feed wheel.

The encapsulated rubber cord on the special feed wheel allows notched material to remain smooth, unmarred, and without serrated impressions. It is particularly useful for sign shop applications and notching of pre-painted aluminum.

RUOFF NOTCHER

CUTS
PRODUCTION
COSTS

RUOFF & SONS, INC.
1030 Rose Avenue
Runnemede, NJ 08078
Phone 609-931-2064
Fax 609-931-0539

(U.S. Patent No. 2,799,336)

SOME OF THE MANY USES OF THE RUOFF NOTCHER

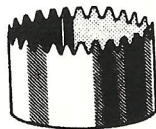

Notched starting
collar for
duct work



Notched standing
seam for fittings



Notched sections for sign work



Notched flange
for metal letters

VARIABLE PATTERNS

VARIABLE DEPTHS

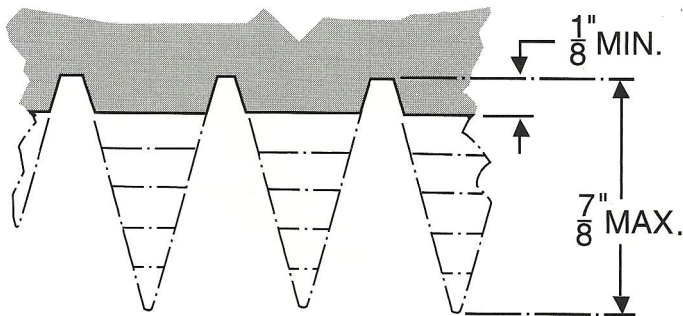

VARIABLE SPACING

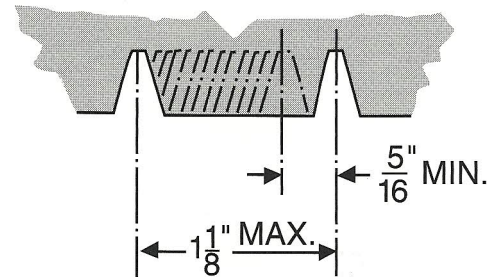

**COMPACT SELF-CONTAINED UNIT PROVIDES SAFETY
AND CONVENIENT TROUBLE-FREE SERVICE**

STANDARD PUNCH AND DIE PATTERNS

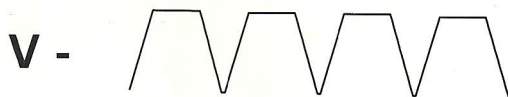

Standard punch and dies provide either a 15° notch or a 3/32" slot. Other patterns are available. The punch and die can be sharpened several times.

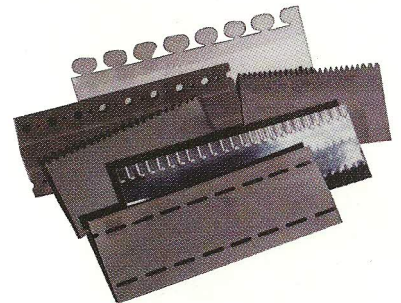

SPECIFICATIONS

OVERALL DIMENSIONS:

18" w x 12" d x 50" h

SHIPPING WEIGHT (crated):

120 lbs.

SPEED:

From 20 feet per minute (240 punches per minute) up

ADJUSTMENTS:

Centers of notches are adjustable up to 1 1/8" max.

Depth of notch is adjustable up to 7/8" max.

ELECTRICAL:

115/230 volts a-c, 11/5.6 amps., 3/4 h.p.

GAUGE:

Up to 16 gauge mild steel—20 gauge stainless.

Other materials in proportion to shear strength (.060 max. thickness).

TO MEET SPECIAL REQUIREMENTS:

The need for notching heavier gauges, wider spacing, or meeting other specific conditions beyond the scope of the standard Ruoff Notcher can often be met by minor modifications. Inquiries are invited regarding these special needs.

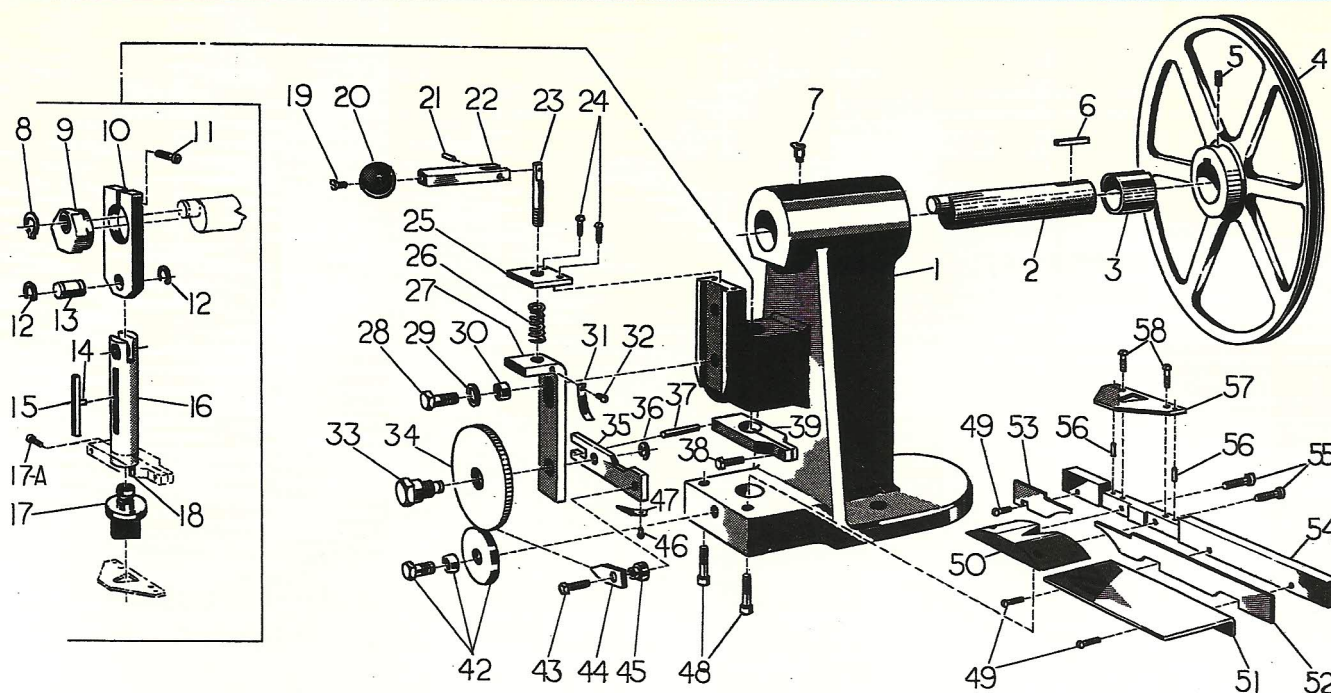

*To ensure a correct fit, the components (part #s 17,50,54,55,56,57 and 58) of the Punch & Die Assembly are made and assembled as a unit and are not interchangeable. Punch & Die Assemblies can be returned to Ruoff & Sons for free estimate to replace and/or repair individual components. Component parts of Punch & Die Assembly may not be ordered separately.

PARTS LIST

- | | | |
|----------------------------------|-------------------------------|--|
| 1. Casting | 22. Lever | 48. Die Screws |
| 2. Crankshaft | 23. Stud | 49. Table Screws and Spacer Screws |
| 3. Pulley Sleeve | 24. Top Plate Screws | 50. Die |
| 4. Pulley | 25. Top Plate | 51. Table |
| Standard -Single Groove | 26. Coil Spring | 52. Long Spacer |
| Heavy Duty-Double Groove | 27. Sliding Bracket | 53. Short Spacer |
| 5. Pulley Set Screw | 28. Sliding Bracket Screw | 54. Guide Bar |
| 6. Pulley Key | 29. Sliding Bracket Washer | 55. Guide Bar Screws |
| 7. Oil Cup | 30. Sliding Bracket Bushing | 56. Stripper Plate Dowel Pins |
| 8. Crankshaft Retaining Ring | 31. Feed Wheel Spring | 57. Stripper Plate |
| Waldes Truarc #5105-50 | 32. Feed Wheel Spring Screw | 58. Stripper Plate Screws |
| 9. Eccentric Hex Bushing | 33. Feed Wheel Shoulder Bolt | The following parts are not shown on the illustration: |
| 10. Connecting Link | 34. Feed Wheel | 59. Stand |
| 11. Connecting Link Screw | 35. Rocker Arm | 60. Pulley Guard with Bracket |
| 12. Connecting Link Pin | 36. Feed Wheel Shoulder Screw | 61. Scrap Bucket |
| Retaining Rings-Waldes | Retaining Ring-Waldes | 62. Motor |
| Truarc #5103-50 | Truarc # 5133-25 | Standard-1/4 H.P. |
| 13. Connecting Link Pin | 37. Collar Dowel Pin | Heavy Duty-3/4 H.P. |
| 14. Ram Key Self Lock Pin | 38. Collar Screw | 63. Motor Pulley |
| 15. Ram Key | 39. Collar | Standard-Single Groove |
| 16. Ram | 42. Support Wheel Assy. | Heavy Duty-Double Groove |
| 17. Punch | (incl #40 & #41) | 64. V-Belt |
| 17A Punch Set Screw | 43. Pawl Screw | 65. On-Off Switch |
| 18. Punch Locating Self Lock Pin | 44. Pawl | 66. Rubber Cord with Plug |
| 19. Lever Knob Screw | 45. Pawl Bushing | |
| 20. Lever Knob | 46. Pawl Spring Screw | |
| 21. Lever Self Lock Pin | 47. Pawl Spring | |