

Complete Assembly No. 400-1

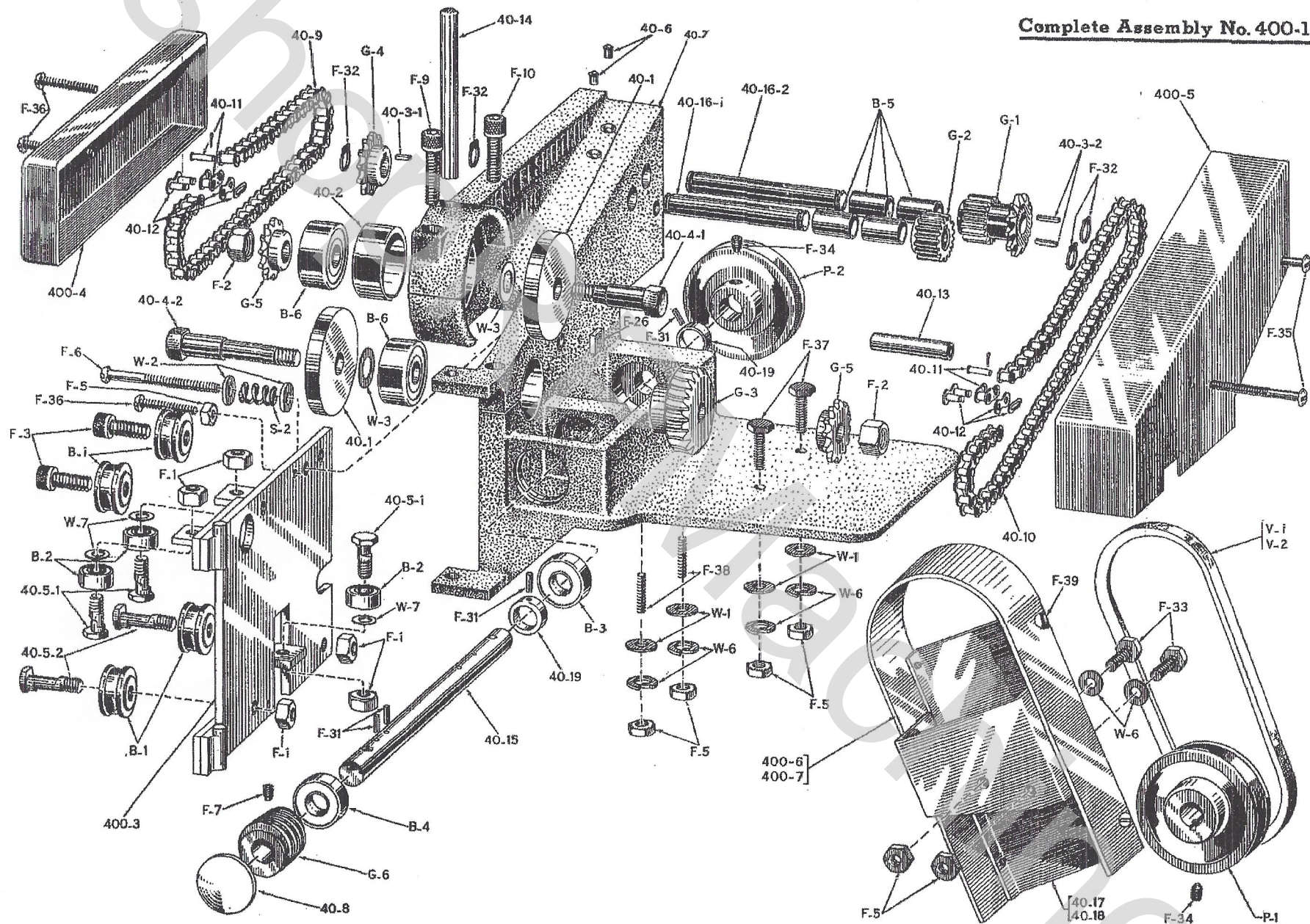

CUTTER PART NUMBERS

Qty. Per Cutter	Part No.	Description
2	40-1	Cutter Wheel
1	40-2	Adjuster Bushing
1	40-3-1	Key 1/4x1/4 long
2	40-3-2	Key 1/4x3/8 long
1	40-4-1	Cutter Bolt 2-1/16 long (upper)
1	40-4-2	Cutter Bolt 3 1/8 long (lower)
3	40-5-1	Eccentric Bolt 15/16 long (side bearing)
2	40-5-2	Eccentric Bolt 1 1/8 long (track bearing)
2	40-6	Oiler
1	40-7	Cutter Casting
1	40-8	Plug (disk)
1	40-9	Chain (54 links)
1	40-10	Chain (82 links)
2	40-11	Offset Connecting Link
2	40-12	Master Connecting Link
1	40-13	1/2 Pipe 2 1/8 long (spacer)
1	40-14	Cutter Handle
1	40-15	Drive Shaft
1	40-16-1	Shaft 3-9/16 long
1	40-16-2	Shaft 3-15/16 long
1	40-17	Guard Cover for 20 Ga. Cutter
1	40-18	Guard Cover for 18 Ga. Cutter
2	40-19	Collar

ASSEMBLIES

1	400-1	Cutter (complete)
1	400-2	Hole location for "Kooled Kord" Mounting Bracket
1	400-3	Back Plate (welded assembly)
1	400-4	Back Chain Guard
1	400-5	Front Chain Guard
1	400-6	Belt Guard for 20 Ga. Cutter
1	400-7	Belt Guard for 18 Ga. Cutter

PULLEYS

1	P-1	Adjustable Pulley
1	P-2	Plain Pulley

BELTS

1	V-1	"V" Belt (for 20 Ga. Cutter)
1	V-2	"V" Belt (for 18 Ga. Cutter)

Cutter Parts and Part Numbers (Continued from preceding page)

FASTENERS

Qty. Per Cutter	Part No.	Description
5	F-1	3/8 Hex Nut
2	F-2	1/2 Hex Nut
2	F-3	3/4x1 Allen Skt. Hd. Cap Screw (track bearing mtg.)
7	F-5	1/4 Hex Nut
1	F-6	1/4x3 Rd. Hd. Stove Bolt (back plate adjuster)
1	F-7	5/16x5/16 Dg. Pt. Allen Set Screw (worm)
1	F-9	3/4x1 1/2 Allen Skt. Hd. Cap Screw (upper adj.)
1	F-10	3/4x1 1/4 Allen Skt. Hd. Cap Screw (lower adj.)
1	F-26	1/4 Square Nut
4	F-31	1/4x3/8 Rollpin
4	F-32	1/2" Retaining Rings
2	F-33	1/4x1/2 Hex Hd. Cap Screw
1	F-34	5/16x3/8 Allen Set Screw (pulley)
2	F-35	1/4x2 1/2 Rd. Hd. Stove Bolt
3	F-36	1/4x1 1/2 Rd. Hd. Stove Bolt
2	F-37	1/4x1 Hex Hd. Cap Screw
2	F-38	1/4x3/8 Stud
4	F-39	1/2x#10 Sht. Mtl. Screw

WASHERS

4	W-1	3/8 I.D. x 3/8 O.D. Plain Washer
2	W-2	5/16 I.D. x 3/4 O.D. Plain Washer
2	W-3	3/8 I.D. x 1 O.D. x .020 Shim
6	W-6	1/4 Lock Washer
3	W-7	3/8 I.D. x 3/8 O.D. x .064 thick

BEARINGS

4	B-1	Track Bearing
3	B-2	Support Bearing
1	B-3	Drive Shaft End Bearing
1	B-4	Drive Shaft End Bearing with Grease Seal
4	B-5	1/2 O.D. x 3/8 I.D. Bronze Bushing
2	B-6	Cutter Wheel Bearings

GEARS

1	G-1	Spur & Sprocket Comb.
1	G-2	Spur Gear
1	G-3	Bronze Worm Gear
1	G-4	Idler Sprocket
2	G-5	Cutter Wheel Sprocket
1	G-6	Worm

SPRINGS

1	S-2	Spring
---	-----	--------

MOTORS

1	M-1	1/2-hp 110 V. A.C. Single Phase, 60 Cycle, 1725 RPM
1	M-2	3/4-hp 110 V. A.C. Single Phase, 60 Cycle, 1725 RPM

(Continued on Next Page)